

X-CALIBUR V

DENTAL CHAIR

BEL-50

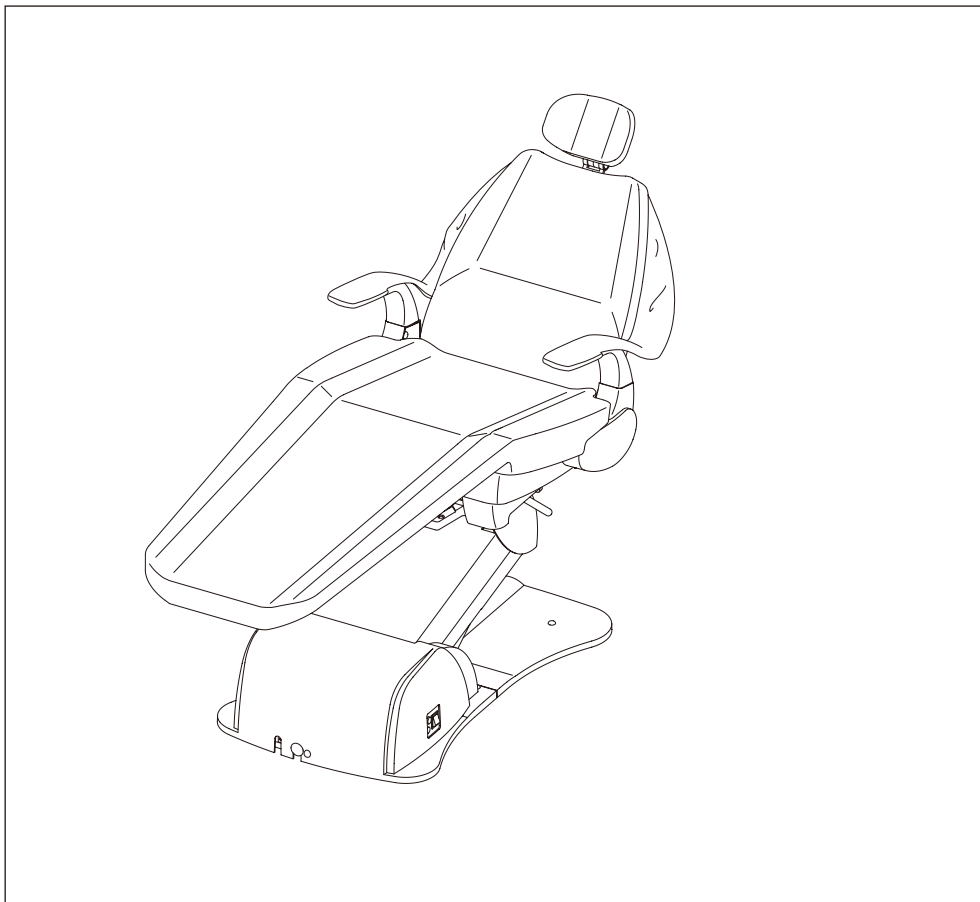

**INSTALLATION
INSTRUCTIONS**

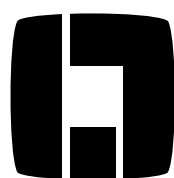
 **Belmont[®]**

AEFS97A0

BEL-50 Chair Installation Procedures

- 1) Place chair carton close to installation location.

Remove all the staples fixing the carton to pallet, or cut the carton just above the stapled line, and remove the carton.

(See Figure 1.)

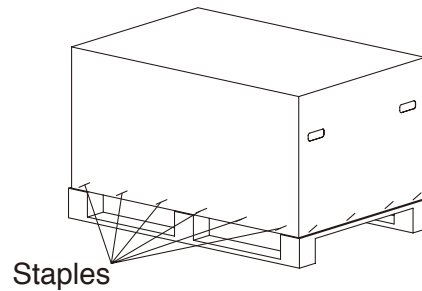

Figure 1

- 2) Using a 10mm socket, loosen and remove two packing screws holding the chair base into pallet. (See Figure 2.)

- 3) Lift chair base from pallet into the installation location.

Be sure to lift chair under the side frame and main link axis as shown in Figure 2.

Do not lift chair by toeboard bar

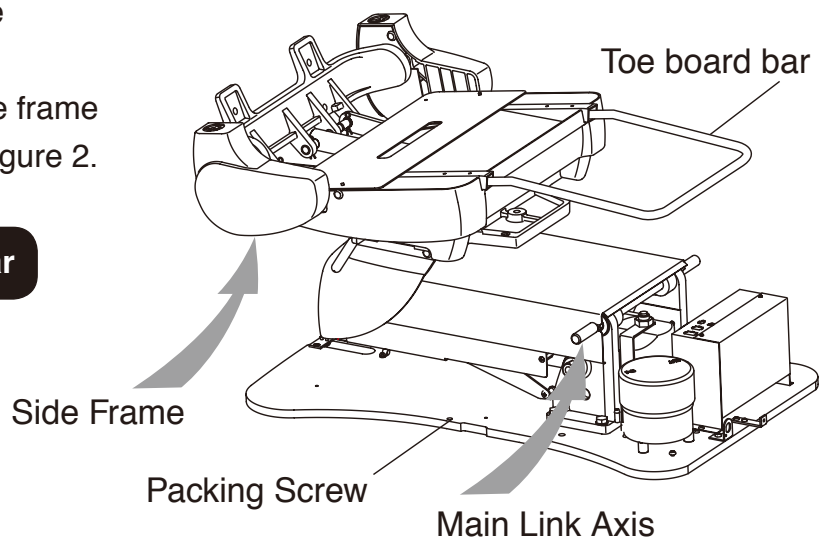

Figure 2

- 4) Before attaching chair to the electrical power source, remove red shipping bolt from the seat structure using a 13mm socket. (See Figure3.)

- 5) Remove the following items from chair packaging:

- Backrest Frame Assembly
- Metal Seat
- Plastic Base Cover
- Small Carton Box Containing Armrests, Headrest Mechanism and Bag of Hardware.

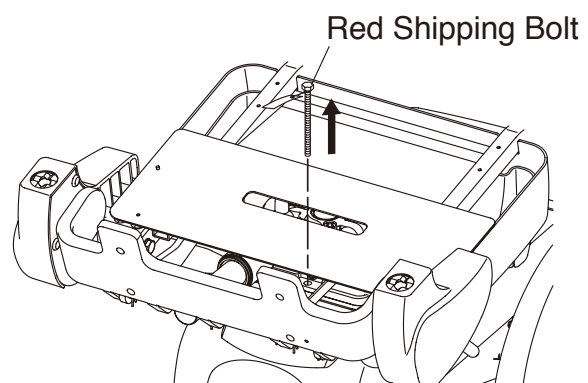

Figure 3

- 6) Plug chair into electrical power source.
Raise the seat by foot switch.

7) Attach each armrest to side frame as shown in Figure 4 (it may be necessary to lightly lubricate armrest shaft with silicone lube).

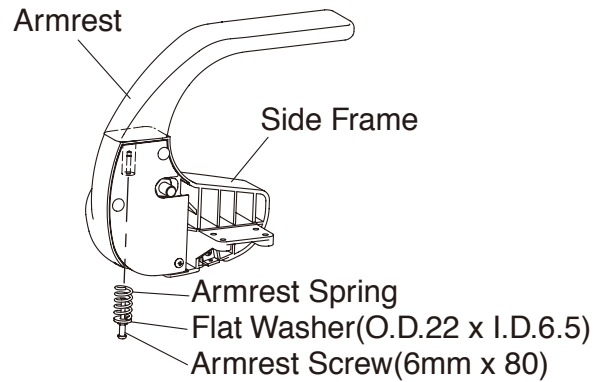

Figure 4

8) Remove 2(5mm x 8) phillips head screws that secure the plastic backrest cover to the metal backrest frame (Figure 6). Using a 10mm hex key wrench, attach backrest frame to seat back support using 4(10mm x25) socket head cap screws. (See Figure 5 a.)

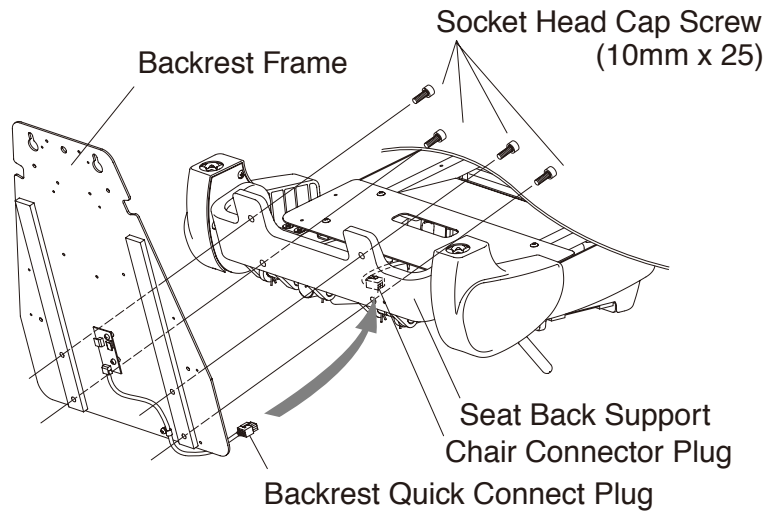

Figure 5 a

9) Connect backrest quick connect plug to chair connector plug (tie up an excess wire with a cable tie). (See Figure 5 a.)

10) Attach metal seat to seat frame, using 4(5mm x 6) phillips head screws. (See Figure 5 b.)

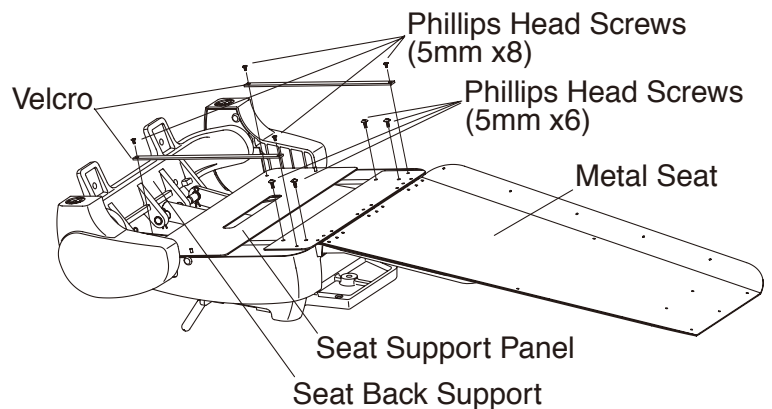

Figure 5 b

11) Fasten 2 velcro strips to holes on metal seat and seat support panel using 4(5mm x 8) phillips head screws, as shown in figure 5b.

12) Re-attach plastic backrest cover to backrest frame, as follows;

- a) Insert backrest cover alignment bolts into eyelet holes in backrest frame, as shown in figure 6a.
- b) Press backrest cover against backrest frame and push backrest cover upward. Make sure the 2 small threaded brackets on the lower edge of the backrest frame are inside of the backrest cover.

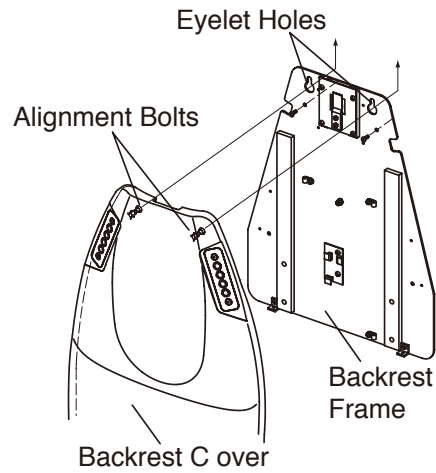

Figure 6a

- c) Secure backrest cover to backrest frame using 2 (5mm x 8) phillips head screws, as shown in figure 6b.

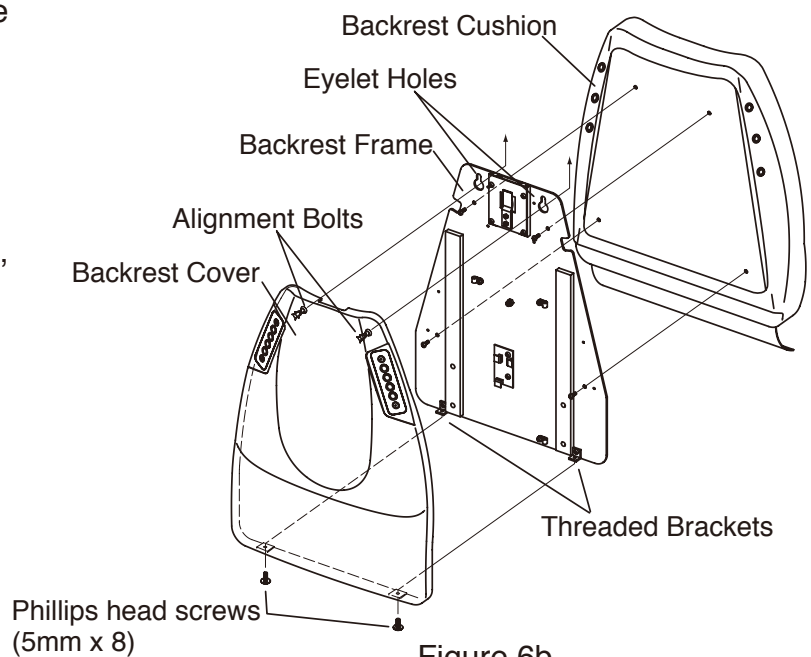

Figure 6b

13) Attach headrest cushion to headrest mechanism using 4(10-24 x 3/4) phillips flat head screws and slide headrest bar into opening in top of backrest. (See Figure 6c)

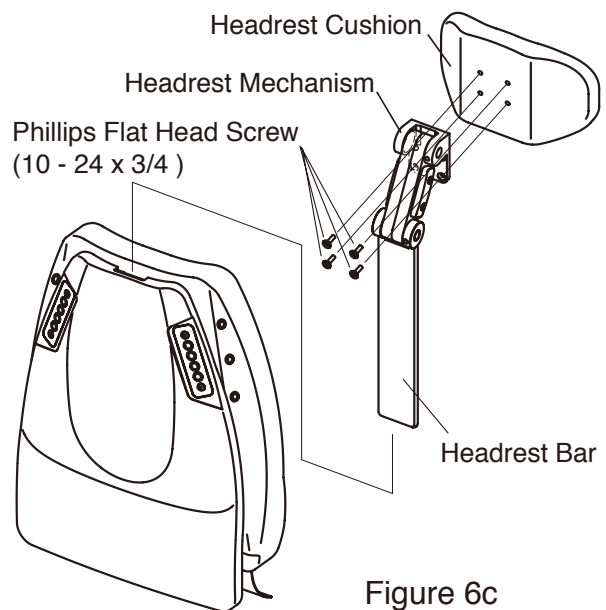

Figure 6c

- 14) Locate the red warning tag which is attached by a string to the rubber air vent plug in the pump reservoir. Normally a brisk tug on this tag will release the plug without the need to open the pump covers. (See Figure 7)

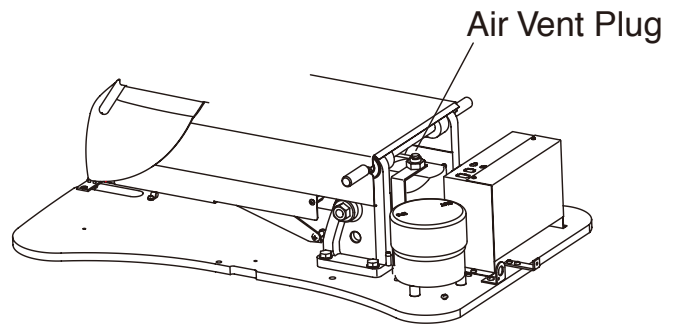

Figure 7

- 15) Using a phillips screwdriver, attach plastic base and pump covers to the base plate with 5 (5mm x 12) screws with countersink washers & plastic screw caps. (See Figure 8)

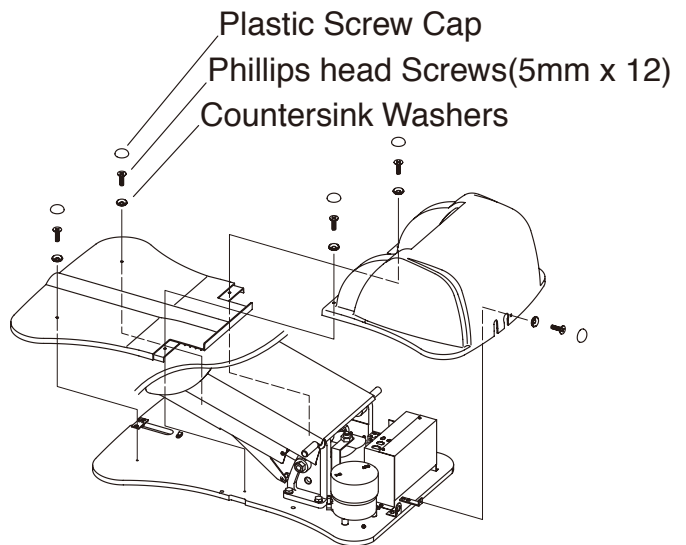

Figure 8

- 16) After the installation has been completed, check all the chair functions as per operation manual.

- 17) Operating speed Controls (Figures 9a and 9b)

Seat and backrest motion speeds are preset at the factory, but can be changed if desired,

Increasing speed - Using a slotted screwdriver or wrench, turn seat or backrest adjustment screw counterclockwise.

Decreasing speed - Using a slotted screwdriver or wrench, turn seat or backrest adjustment screw clockwise.

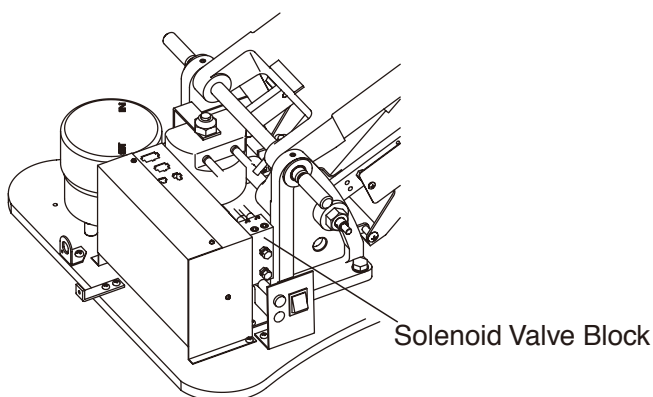

Figure 9a

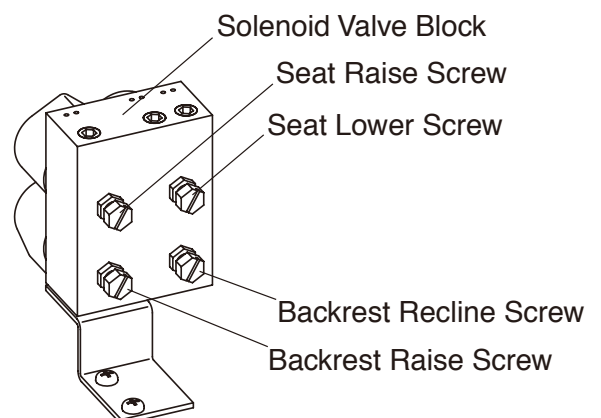

Figure 9b

18) Setting Seat Motion Control Limits (Figures 10 & 11)

Raise the seat half way up.

Turn off the power.

Remove the pump cover for access to the chair control PCB.

Remove the PCB enclosure cover by unscrewing two screws. Turn on power.

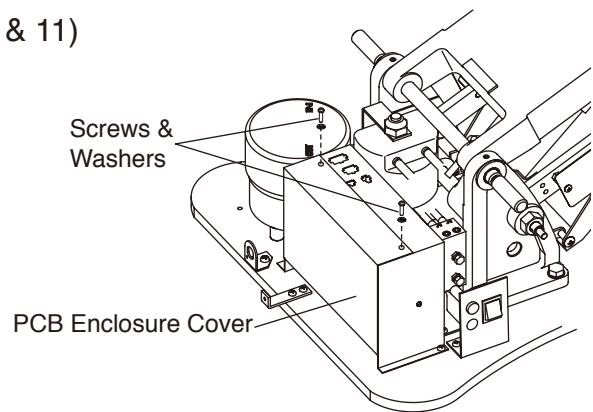

Figure 10

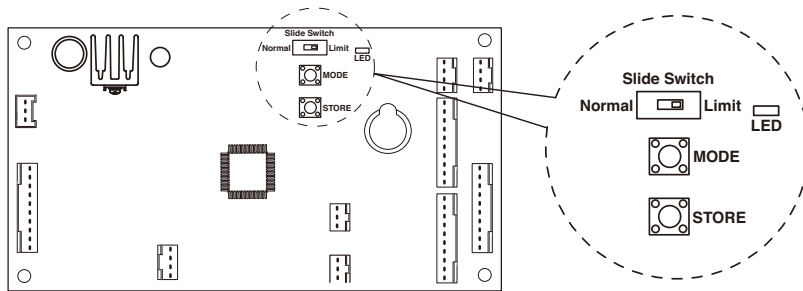

Figure 11 (Control PCB)

Set the slide switch on upper right corner of the PCB to the “Limit” position. Red LED will light and beeper will sound at 1.5 second intervals.

IMPORTANT

To avoid a malfunction when setting lower limit, make sure that there is clearance between the safety plate and the chair base.

If a swing mounted delivery system is attached to the chair, set lower travel limit so delivery system components do not contact chair pump and cantilever lift arm covers.

Using the foot control, backrest controls or optional touchpad, move the seat to the desired position (seat low, seat high, backrest recline and backrest up).

Press orange button located on the PCB marked “Store”, then using the foot control, backrest controls or optional touchpad press the desired limit you wish to set. Beeper will sound.

Move slide switch to position marked “Normal” and test stored limit function(s).

Example: Setting the Lower Seat Limit

- 1) Slide the Normal-Limit switch to the Limit position
- 2) Move the seat base to the desired lowest position. (See Important box on above)
- 3) Press the “Store” button on the PCB
- 4) Press the seat base down switch using the foot control, backrest controls or optional touchpad. A beeper will sound.
- 5) Slide the Normal-Limit switch to the “Normal” position.
- 6) Raise the seat base using the foot control, backrest controls or optional touchpad and then lower it to be sure it stops at the desired position.

SPECIFICATIONS:

DIMENSIONS INCHES

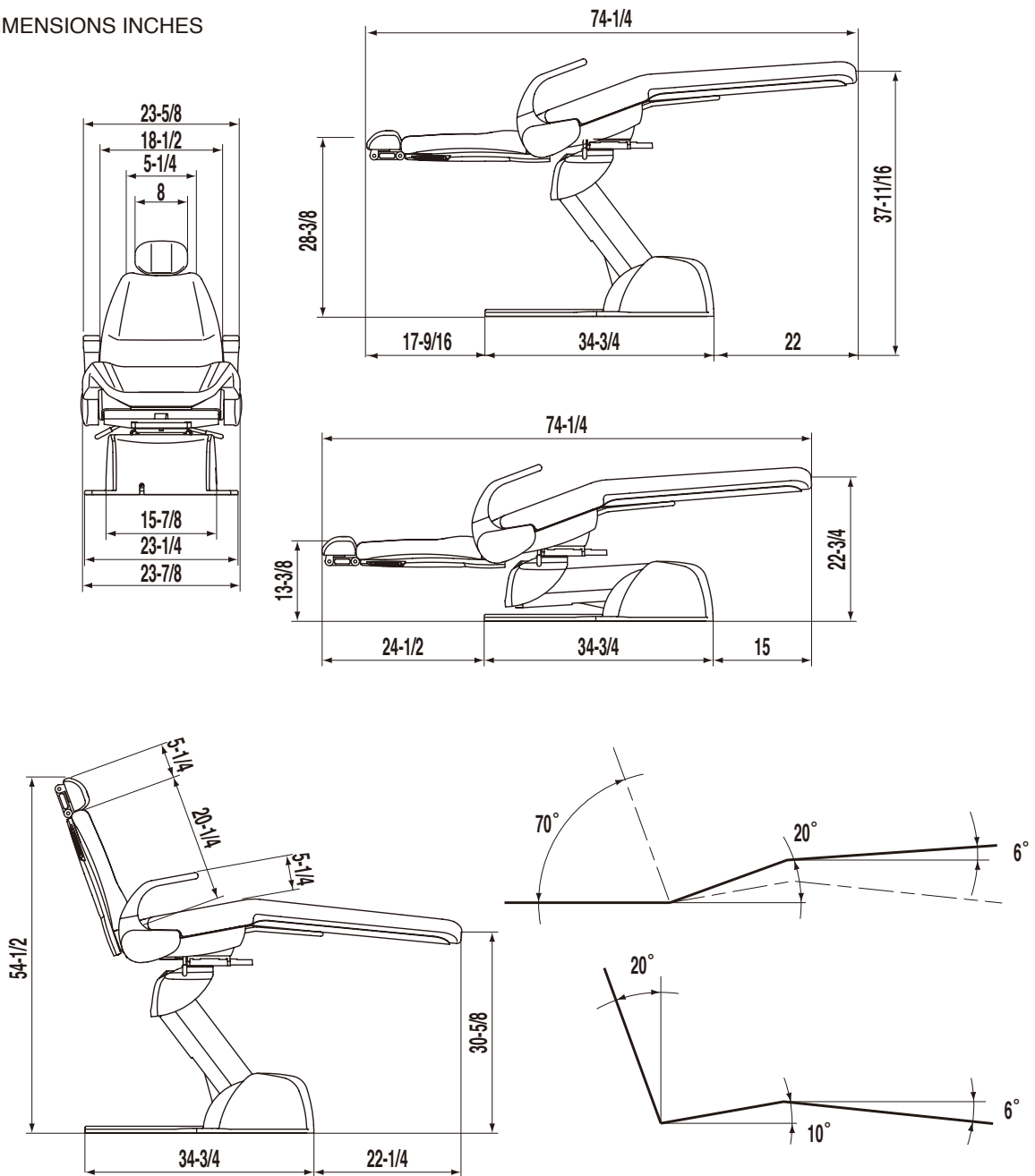

- * Sealed hydraulic system powered by 3.5 A motor pump
- * Base plate: 1/2" steel
- * Bearings at link points - low friction in steel jacket.
- * Steel seat cradle
- * Steel backrest support
- * Electrical requirements: 115 VAC, 3.5 A
- * Hospital grade plug
- * Base component housing formed from solid color acrylonitrile ethylene styrene (AES)
- * All exposed ferrous parts covered with corrosion-resistant paint or plating
- * Weight: 381 lbs. (173 kg)

MEMO



BELMONT EQUIPMENT, Division of Takara Belmont, USA, Inc.

101 Belmont Drive Somerset, New Jersey 08873 U.S.A. TEL.:(732) 469-5000 / (800) 223-1192 Fax.:(732)526-6322 / (800) 280-7504

www.belmontequip.com

TAKARA CO, CANADA LTD.

2076 S. Sheridan Way, Mississauga, Ont., L5J2M4, Can. TEL.:(905) 822-2755 Fax.:(905)822-6203

www.takarabelmont.ca